



product data sheet

2-component Dispenser ViscoDuo-P 4/4

application



The 2-component dosing system ViscoDuo-P 4/4 is a valveless, static mixing head with dispensers located directly in front of the mixer. Especially developed for simplified cleaning (Easy Clean) and maintenance. In the mixing head no valves are required. The components to be mixed are dosed by volume only and with no dead space into the static mixer.

- compact system design, weight-optimized, optionally cascadable
- processing of viscous materials unfilled or very high filler content
- only low supply pressure required for material feed
- adjustment of the desired mixing ratio by adjusting the speed ratio of both dispensers
- reverse-flow possible (no dripping or stringing of product)
- linear relation between speed and dosing quantity
- constant dosing volume, even with density or viscosity changes due to temperature fluctuations or batch change
- simple programming of volume and dosing speed

application

- static mixing of two components of same or different viscosities
- potting dot or bead applications possible
- suitable for 2-component adhesive systems based on: epoxy resin (EP), polyurethane (PU), silicone (Si), polyester resin (UP), acrylates

technical data

Theoretical dosing volume per mixing head part	0.05 ml/U
Theoretical flow rate per mixing head part	0.05 to 6.25 ml/min
Minimum dosing volume per mixing head part	0.01 ml*
Accuracy in ml ± (absolute)	± 1 %
Repeatability	>99 %
Max. inlet pressure	0 to 10 bar
Max. dosing pressure	0 to 30 bar
Ambient operating conditions	+10 to +80 °C (T _{outside}), atmospheric pressure 1 bar
Material temperature	+10 to +80 °C
Storage conditions / temperature	dry and free of dust / -10 to +40 °C
Weight	1.2 kg
Speed	0 - 120 1/min
Mixing ratio	1:1 to 10:1 (depending on the version)
Static mixer	bayonet connection

*depends on mixing ratio and viscosity of the dosed material

**All values given are approximate values for low to medium viscosity materials (max. 20,000 mPas). The values may vary according to viscosity of the material, pressure, miscibility of the materials, static mixer and mixing ratio.



drawing

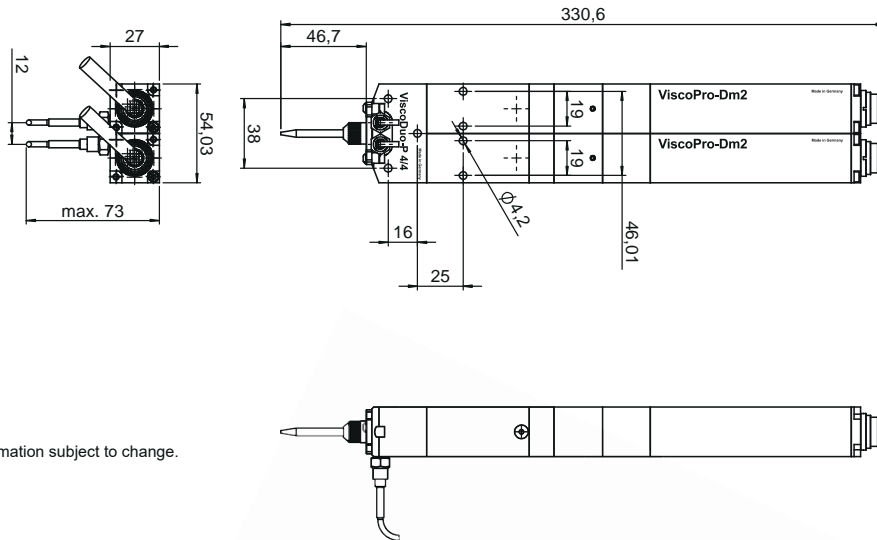

item information

scope of delivery

- 2-component dispenser ViscoDuo-P 4/4-EC with two sensors
- drive unit with brushless EC servo motor and planetary gears
- maintenance manual

necessary and optional components

- 2-component dosing control ViscoDos-4000 2K
- monitoring of material feed
- material supply systems

illustration

